

APT. 403
B2b
 ground floor / planta baja
 2 BEDROOMS / 2 DORMITORIOS
 BUILT AREA / SUPERFICIE CONSTRUIDA: 138,15 m²

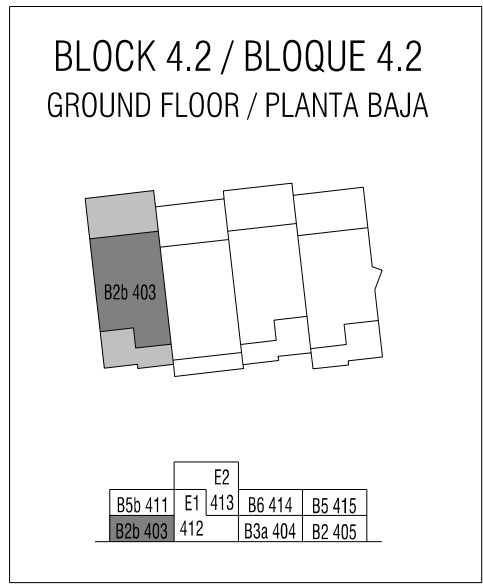
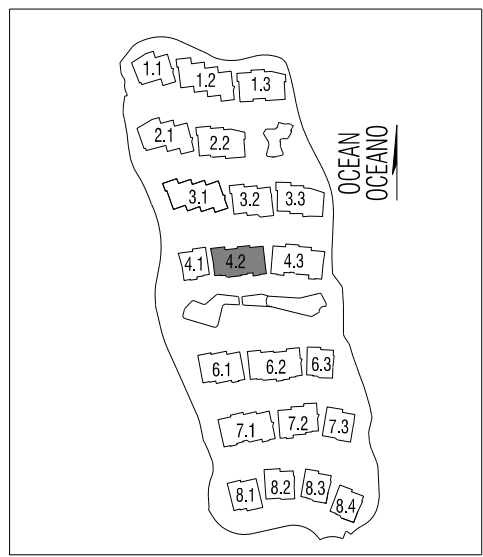

INDOOR USABLE AREA / SUPERFICIE UTIL INTERIOR: 93,30 m²

| | |
|------------------------------|----------------------|
| living room / salón-comedor: | 32,70 m ² |
| kitchen / cocina: | 8,20 m ² |
| bedroom 1/ dormitorio 1: | 18,20 m ² |
| bedroom 2/ dormitorio 2: | 12,70 m ² |
| bathroom 1 / baño 1: | 7,60 m ² |
| bathroom 2 / baño 2: | 5,50 m ² |
| entrance hall / hall: | 1,90 m ² |
| corridor / pasillo: | 3,80 m ² |
| hall / distribuidor: | 2,70 m ² |

TERRACES / TERRAZA TOTAL: 52,50 m²

PRIVATIVE GARDEN / JARDIN PRIVATIVO : 66,60 m²

* Project and plans in draft phase and subject to change / * Proyecto en fase de redacción sujeto a modificaciones

